

BÔVELL



FOR SALE

KYD\$309,000

Current

Cayman Brac, South Side East Rd. 1.25 acre parcel

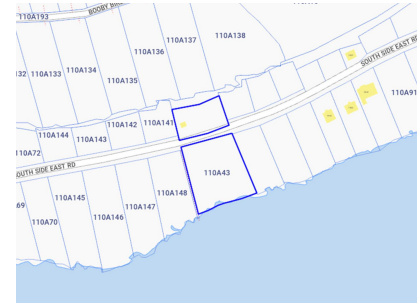

Parcel 43 is located on South Side East Rd. with 212 ft.

Location: Cayman Brac

MLS: 418349



Contact James

james.bovell@bovell.ky

+1 (345) 945 4000

BÔVELL



2024 © RE/MAX Cayman Islands. All rights reserved. Proud member of CIREBA.

RE/MAX CAYMAN ISLANDS

Each office is independently owned and operated. Member of CIREBA and NARS.

The information contained herein has been furnished by the owner(s) and/or their nominee and represented by them to be accurate. RE/MAX Cayman Islands, its agents and employees disclaim any liability or responsibility for any inaccuracies, errors, or omissions in the represented information. All the information contained herein is subject to errors, omissions, price changes, prior sale, or withdrawal, without notice and is at all times subject to verification by the purchaser(s).

BÔVELL



FOR SALE

KYD\$309,000

Current

Cayman Brac, South Side East Rd. 1.25 acre parcel

ADDITIONAL INFORMATION

| | | | | | |
|---------------------|-----|-------|---|------------------|------------|
| Aprx Water Frontage | 212 | Title | Cayman Brac, South Side East Rd. 1.25 acre parcel | Land Certificate | Not Issued |
|---------------------|-----|-------|---|------------------|------------|

RUNNING COSTS

| | | | | | |
|-----------------------------|----|-----------------------------------|----|--------------------------------|----|
| Sewage in Maintenance Costs | No | AC in Maintenance Costs | No | Gardening in Maintenance Costs | No |
| TV in Maintenance Costs | No | Insurance Included in Maintenance | No | Pest in Maintenance Costs | No |

BÔVELL



2024 © RE/MAX Cayman Islands. All rights reserved. Proud member of CIREBA.

RE/MAX
CAYMAN ISLANDS

Each office is independently owned and operated. Member of CIREBA and NMLS.